

1 TREE PROTECTION FENCE
N.T.S.

GENERAL

- The Tree Management/Preservation Plan is to be read in conjunction with the associated Arborist Report prepared by IBI Group and shall not be utilized as a standalone document.
- All existing trees at property boundaries and on adjacent properties shall be preserved and protected. Where trees which are located at shared property boundaries or on adjacent properties are identified by this plan to sustain injury or require removal, the Owner of the adjacent property's written permission is required prior to any construction or removals works commence.

TREE PROTECTION FENCING

- The Contractor shall install Tree Protection Fencing (TPF) to protect trees identified for preservation.
- All TPF will conform with the Arborist Report and detail(s) included on these plans. Where current governing Municipal/City standards differ, contact Project Arborist or Contract Administrator for direction.
- No substitutions of materials, products or quantities will be accepted without the prior written permission of the Project Arborist.
- Upon installation of the TPF, the Contractor shall contact the Project Arborist to review and approve the fencing and location(s) in writing prior to commencement of any site work.
- The TPF shall remain in the approved locations throughout the duration of the site works and shall not be moved at any time to accommodate construction or site work.
- The Contractor shall inspect TPF weekly and maintain as required through all stages of development/construction. The TPF shall be removed at the completion of all site works and disturbed areas shall be restored to original condition.

TREE PRESERVATION

- The Tree Protection Zone (TPZ) is protected and delineated by the TPF or as otherwise defined in the approved Arborist Report. The Contractor is not to proceed in uncertainty.
- Any potential or incurred injury/damage to adjacent trees identified to be preserved shall be immediately reported to the Project Arborist and reviewed on site. Injury/damage includes any required arboricultural treatment including but not limited to: limb pruning, trunk damage, root exposure or required cutting/removal or any other activity that has the potential to harm the tree.
- The TPZ is not to be used for any type of storage including materials, equipment or stockpiles.
- No trenching or tunneling for underground services shall occur within the TPZ.
- Any equipment use within the TPZ will be restricted throughout all stages of development. This applies to TPZs within or outside of the project limit line.
- Absolutely no alteration of grades or construction activity is permitted within the TPF and TPZ. Absolutely no flushing of contaminants shall be permitted towards or within the TPZ.
- When working adjacent to trees to be preserved site preparation measures such as pruning for overhead clearance may be required. Preparatory pruning shall only be performed when completed by or under the direct supervision of an ISA Certified Arborist (or approved qualified person as approved by the Project Arborist).
- All pruning work shall be performed by a qualified individual and shall be in accordance with current horticultural practices including but not limited to:
 - Pruning cuts shall be made just beyond the branch collar and should be limited to thinning cuts. Heading cuts will only be accepted in specific cases as directed by an arborist and should be avoided where possible.
 - Pruning of all stems greater than 50 mm in diameter should be made with a three-cut method to avoid tearing living bark tissue.
 - No wound dressings shall be applied.
- Where soil excavation/grading work is required within the rooting zone of a tree to be preserved (the rooting zone often extends beyond the identified TPZ and can be 3 times the dripline radius or more):
 - Roots shall be cleanly severed before stripping and removing soil to avoid damage to the tree and the root system. Roots to be cut using appropriate equipment (i.e. trencher adapted to this specific use/chainsawroot pruning machine). Roots may be severed using the clean edge of a straight excavator bucket under supervision of an ISA Certified Arborist.
 - No attempts to cut existing roots with the digging bucket of any heavy machinery will be permitted as it can cause the roots to tear and pull and be harmful to root regeneration and recovery.
 - Any exposed roots of a tree to be preserved with a diameter greater than 2.5cm (1 inch) shall be pruned back to the soil face.
 - An excavation area within the TPZ shall be backfilled immediately and/or roots shall be kept constantly moist with burlap covered with white plastic and checked a minimum of 2 times a day, for a maximum of 48 hours. If roots are to be exposed for a period greater than 48 hours, the exposed area shall be covered with a minimum of 150 mm (6 inches) of mulch and maintained in a moist condition during construction until the area can be properly backfilled.
- Trees shall not have any rigging cables, fencing, signage or hardware of any sort attached or wrapped around them.
- No contaminants or toxic materials shall be dumped or flushed where they may come into contact with the feeder roots of trees to be preserved.
- The Contractor will be held responsible for all avoidable damage to preserved trees during all stages of construction.
- Watering or other maintenance of trees to be preserved may be required if construction activities are observed to be causing stress or impacting health as determined by the Project Arborist.

TREE REMOVALS

- Prior to the commencement of tree removals, all trees designated for removal must be clearly identified in the field.
- Where possible, removals, chipping, and/or brush removal is to be completed outside the window of April 1 to August 31. This window accounts for active bird nesting and bat maternity roosting periods. Where removals remain the restricted activity window, nest and roosting habitat assessments to protect species protected under the Migratory Birds Convention Act, 1994 and Endangered Species Act, 2007. These surveys must be completed by a qualified biologist or ornithologist.
- Trees shall always be felled away from adjacent preserved trees to prevent avoidable damage to the crowns and stems

Table 1 - Existing Tree Inventory
191-211 Northumberland Street, Ayr, Ontario

| Tag # | Species | Common Name | Diameter at Breast Height (DBH) cm or range (cm) | Drip Line Radius (m) | Condition | Recommended Action | Notes |
|-------|---------------------|---------------------|--|----------------------|-----------|--------------------|--|
| A | Picea abies | Norway Spruce | 56.5 | 5 | G F | Preserve | Declining crown, top main leader |
| B | Picea abies | Norway Spruce | 70 | 5 | G G | Good | Branching development side only |
| C | Acer saccharum | Sugar Maple | 75 | 8 | F G | Good | Crack in main stem, wound wood present |
| D | Acer saccharum | Sugar Maple | 98 | 9 | F G | Good | Large limb overhanging property |
| E | Picea abies | Norway Spruce | 58 | 5 | F F | Fair | Two leaders, suppressed by Tree D, union @ 2.2m with included bark. |
| F | Picea abies | Norway Spruce | 49.5 | 4 | G F | Good | Partially suppressed by Tree G |
| G | Acer saccharum | Sugar Maple | 83 | 8 | G G | Good | Minor internal debark (10%) on driveway side only. |
| H | Picea abies | Norway Spruce | 54 | 5 | F G | Good | Branching development side only |
| I | Picea abies | Norway Spruce | 44 | 4 | G F | Good-Fair | Branching development side only |
| J | Picea abies | Norway Spruce | 69 | 6 | G G | Good | Decline in crown 15% - Driveway side |
| K | Acer saccharum | Sugar Maple | 97 | 6 | F P | Fair/Poor | Hollow in main stem with cracks at branching union. Potential structural risk |
| L | Acer saccharum | Sugar Maple | 19 | 3 | F F | Fair | Damage on stem, suppressed with minimal canopy |
| M | Acer saccharum | Sugar Maple | 13 | 2 | F F | Poor | Damage on stem, suppressed |
| N | Juglans nigra | Black Walnut | 13.5 | 2 | F P | Poor | Extensive vines in crown |
| O | Juglans nigra | Black Walnut | 14 | 2 | F G | Good | Extensive vines in crown |
| P | Juglans nigra | Black Walnut | 16 | 2 | F P | Poor | Extensive vines in crown |
| Q | Juglans nigra | Black Walnut | 43 | 6 | G G | Good | Vines in bottom third of crown |
| R | Juglans nigra | Black Walnut | 33 | 3 | F G | Good | Two leaders, union @ 1.5m about grade |
| S | Juglans nigra | Black Walnut | 10 | 1 | G F | Fair | Suppressed, vines in crown |
| T | Juglans nigra | Black Walnut | 17 | 2 | G F | Fair | Vines in crown - extensive |
| U | Juglans nigra | Black Walnut | 10 | 2 | G F | Fair | Vines in crown - extensive |
| V | Thuja occidentalis | Eastern White Cedar | 16.16 | 2 | G G | Good | On adjacent property |
| W | Populus tremuloides | Trembling Aspen | 27 | 4 | G G | Good | On adjacent property |
| X | Populus tremuloides | Trembling Aspen | 23 | 4 | G G | Good | On adjacent property, crack in stem. To be added to straighten tree |
| Y | Populus tremuloides | Trembling Aspen | 23 | 4 | F F | Fair | On adjacent property, crack in stem. To be added to straighten tree. Declining crown |
| Z | Populus tremuloides | Trembling Aspen | 21 | 4 | G G | Good | On adjacent property |
| AA | Juglans nigra | Black Walnut | 16 | 3 | G G | Good | Remove |
| BB | Juglans nigra | Black Walnut | 10 | 2 | G G | Good | Remove |
| CC | Juglans nigra | Black Walnut | 10 | 2 | G G | Good | Remove |
| DD | Juglans nigra | Black Walnut | 15 | 3 | G G | Good | Remove |
| EE | Juglans nigra | Black Walnut | 10 | 2 | F G | Good | Remove |
| FF | Juglans nigra | Black Walnut | 15.8 | 2 | F G | Good | Remove |
| GG | Acer saccharum | Sugar Maple | -90 | 4 | G G | Good | On adjacent property |
| HH | Ulmus americana | American Elm | 10.8-17 | 3 | F F | Fair | Growing out of house foundation. Sucker growth |
| II | Thuja occidentalis | Eastern White Cedar | 35 | 3 | F F | Fair | Declining crown - top down |
| JJ | Acer saccharum | Sugar Maple | 39 | 4 | F G | Good | Damage on trunk |

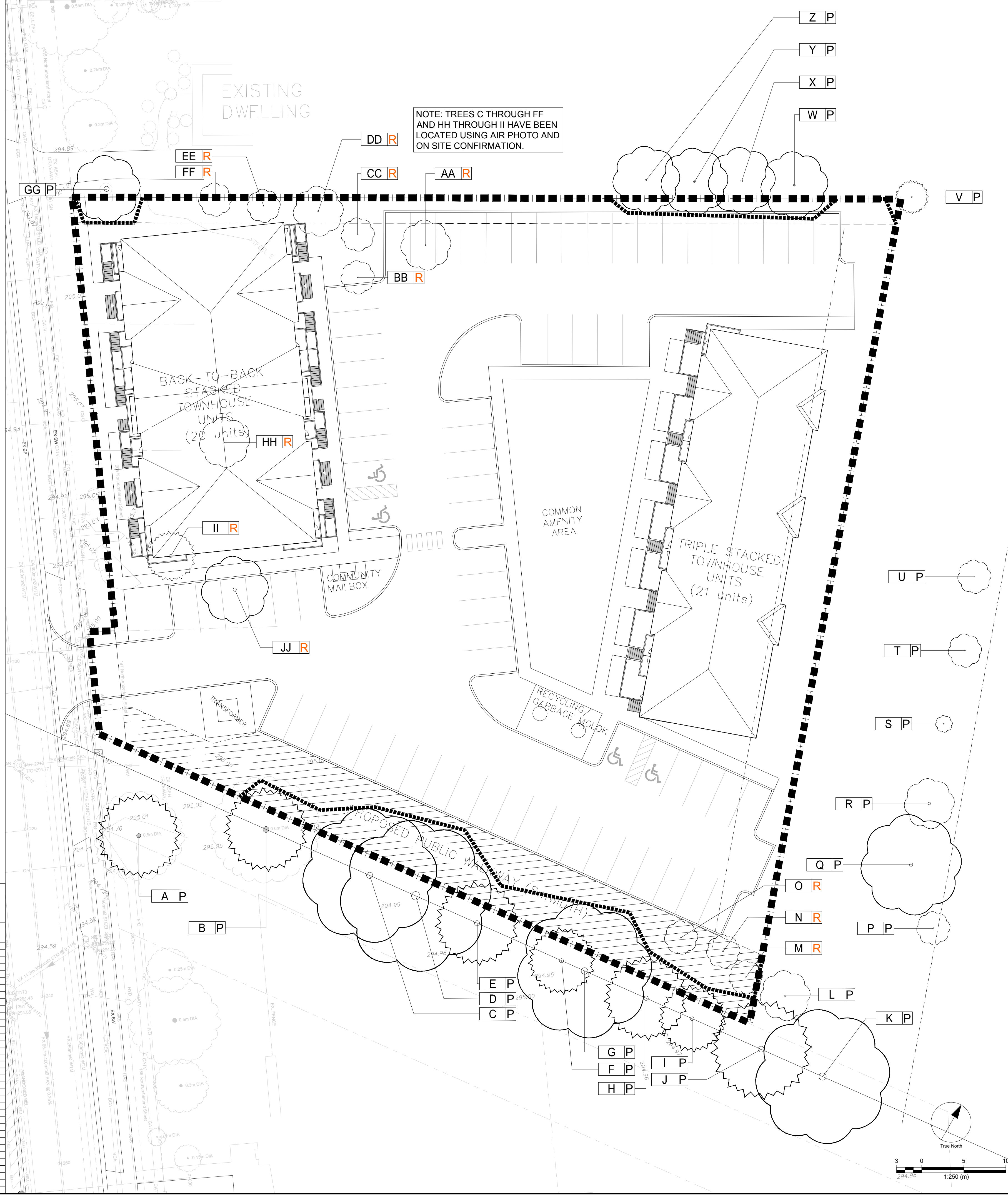

CLIENT
2670708 ONTARIO INC

COPYRIGHT
This drawing has been prepared solely for the intended use. This reproduction or distribution for any purpose other than authorized by IBI Group is forbidden. Written dimensions shall have precedence over scaled dimensions. Contractors shall verify and be responsible for all dimensions and conditions on the job, and IBI Group shall be informed of any variations from the dimensions and conditions shown on the drawing. Shop drawings shall be submitted to IBI Group for general conformance before proceeding with fabrication.
IBI Group Professional Services (Canada) Inc.
is a member of the IBI Group of companies.

ISSUES

| No. | DESCRIPTION | DATE |
|-----|-------------------------------|------------|
| 1 | ISSUED FOR SITE PLAN APPROVAL | 2021-09-09 |

KEY PLAN



LEGEND

EXISTING DECIDUOUS TREE

EXISTING CONIFEROUS TREE

TREE IDENTIFICATION TAGS

0 P - TREE TO BE PRESERVED

0 R - TREE TO BE REMOVED

0 T - TREE TO BE TRANSPLANTED

--- --- TEMPORARY TREE PROTECTION FENCING

==== PROJECT SITE BOUNDARY

IBI GROUP
Suite 101 - 410 Albert Street
Waterloo ON, N2L 3V3 Canada
Tel: 519 565 2255
ibigroup.com

PROJECT
197-211 NORTHUMBERLAND ST. Ayr, TOWNSHIP OF NORTH DUMFRIES

PROJECT NO: 126281
DRAWN BY: E.L.
PROJECT MGR: T.M.

SCALE: 1:200
CHECKED BY: T.M.
APPROVED BY: T.M.

SHEET TITLE
TREE MANAGEMENT PLAN

SHEET NUMBER: **TMP-1** ISSUE: **1**

File Location: \\1126281_Northumberland03_Design\05_Landscape\Sheets\126281_TPM.dwg Last Saved: September 20, 2021, by Raehna Sherry Plot: Tuesday, September 21, 2021, 10:04:19 AM by Raehna Sherry