

PLANT MATERIAL LIST

KEY	QUANT.	BOTANICAL NAME	COMMON NAME	SIZE	COND.
AC	2	Amelanchier canadensis	Serviceberry	70mm cal.	W.B.
AS	4	Acer saccharum Autumn Fest	Autumn Fest Sugar Maple	70mm cal.	W.B.
AR	2	Acer rubrum 'Autumn Flame'	Pyramidal European Hornbeam	70mm cal.	W.B.
Dk	14	Diervilla lonicera 'Kodiak Orange'	Kodiak Orange Bush Honeysuckle	60cm, 3 gal. (#3 Cont.)	Pot
he	48	Hemerocallis 'Stella d'Oro'	Stella d'Oro Daylily	1 gal. (#1 Cont.)	Pot

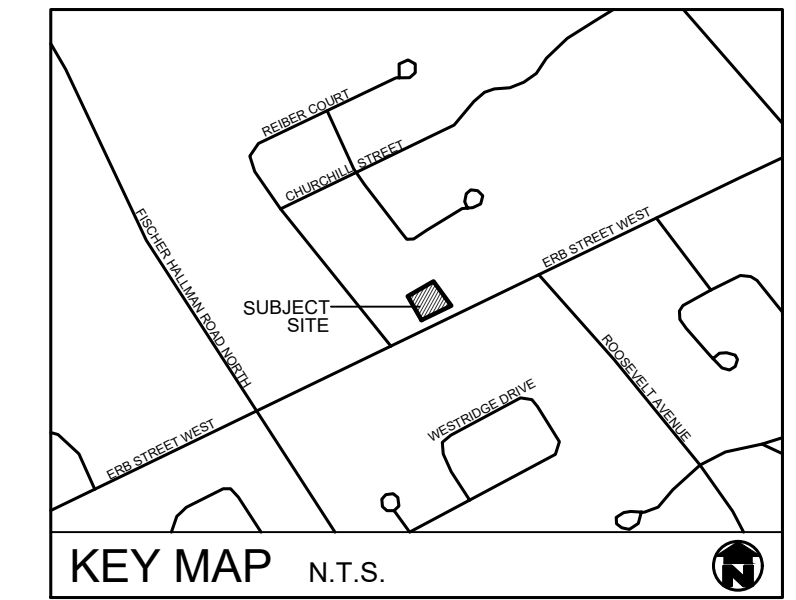
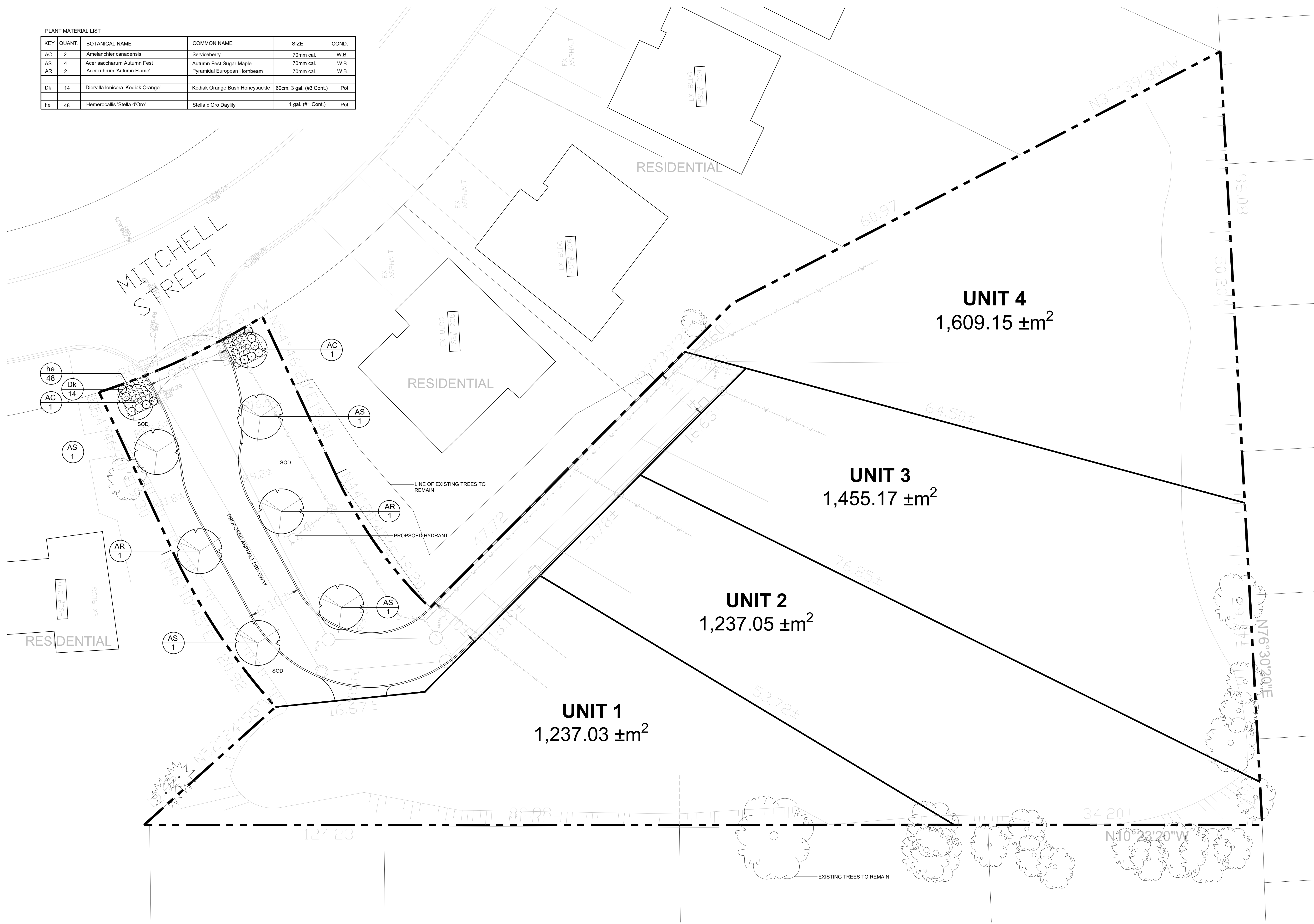

GENERAL NOTES

1. ALL WORKMANSHIP WILL BE TO THE STANDARDS OF LANDSCAPE ONTARIO.
2. ALL PLANT MATERIAL TO BE NO.1 GRADE NURSERY GROWN IN ACCORDANCE WITH THE CANADIAN STANDARDS FOR NURSERY STOCK, 5TH EDITION, 2017, BY THE CANADIAN NURSERY TRADES ASSOCIATION.
3. BACKFILL WILL CONSIST OF SOIL NATIVE TO THE SITE OR GENERAL SOIL TYPE/CLASS NATIVE TO THE SITE. TOPSOIL TO BE TESTED FOR NUTRIENT VALUE, AND AMENDED FOR OPTIMAL GROWTH AS PER THE RECOMMENDATIONS OF THE SOIL TEST.
4. CONTRACTOR SHALL MAINTAIN ALL LANDSCAPE AREAS UNTIL OWNER'S ACCEPTANCE OF PROJECT.
5. CONTRACTOR TO LOCATE ALL UNDERGROUND UTILITIES.
6. PLANTING MAY BE ADJUSTED TO SUIT LOCATIONS OF SITE UTILITY STRUCTURES/SERVICES.
7. ALL MATERIALS MUST BE APPROVED BY LANDSCAPE ARCHITECT PRIOR TO INSTALLATION.
8. SPREAD MULCH TO A MINIMUM OF 100mm COMPACTED DEPTH ON ALL TREE PITS AND PLANTING BEDS.
9. CHECK AND VERIFY ALL DIMENSIONS AND QUANTITIES PRIOR TO COMMENCEMENT OF WORK. ANY DISCREPANCIES ARE TO BE REPORTED IN WRITING TO THE LANDSCAPE ARCHITECT. QUANTITIES NOTED WITHIN THE PLAN SUPERCEDE THOSE IN THE PLANT LIST. ANY SUBSTITUTIONS SHALL BE APPROVED BY THE LANDSCAPE ARCHITECT.
10. SOD AS MARKED WITH NURSERY SOD ON A MINIMUM OF 100mm OF CLEAN TOPSOIL. FINE GRADE AND SOD ALL BOULEVARD AREAS TO MUNICIPAL SPECIFICATIONS AND REPAIR DAMAGE TO ADJACENT PROPERTIES, AS REQUIRED.
11. FINAL INSPECTION AND ACCEPTANCE OF PLANTING WORK SHALL COINCIDE WITH THE FINAL INSPECTION AND ACCEPTANCE OF ALL WORK INCLUDED IN THE CONTRACT.
12. ALL SEEDED SLOPES 3:1 AND GREATER TO RECEIVE EROSION CONTROL MATTING. PIN SOD ON ALL SLOPES OF 3:1 OR GREATER.
13. SUBMIT A WRITTEN GUARANTEE TO THE EFFECT THAT ALL PLANTS ACCEPTED DURING THE PERIOD OF JANUARY 1st TO JULY 15th SHALL BE GUARANTEED UNTIL JULY 15th THE FOLLOWING YEAR. PLANTS ACCEPTED DURING THE PERIOD OF JULY 15th TO DECEMBER 31st SHALL BE GUARANTEED FOR ONE YEAR FROM THE DATE OF ACCEPTANCE. THE GUARANTEE PERIODS LISTED ABOVE SHALL APPLY TO ALL "NURSERY GROWN" PLANTS.
14. AT THE TIME OF FINAL INSPECTION ALL PLANTS SHALL BE IN A HEALTHY, VIGOROUS GROWING CONDITION, PLANTED IN FULL ACCORDANCE WITH DRAWINGS AND CONDITIONS.
15. SITE PLAN INFORMATION AS PER DSH.
16. ENGINEERING AS PER KSMART, AND IS PROVIDED FOR INFORMATION ONLY.
17. SITE LIGHTING BY OTHERS



no.	date	description	by
FO	xx		xx

DSH Planning Consultants Ltd.  
Mitchell Street  
Ayr, ON

Landscape Plan



PROJECT NO: 2023-38 DRAWN BY: DPV  
SCALE: 1:200 DESIGNED BY: DPV  
SHEET: L1 APPROVED BY: AWH  
PLOT DATE: x

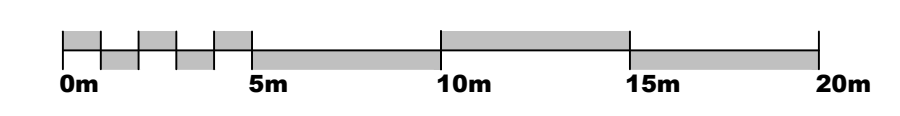

TREEGATOR:

INSTALL TREEGATOR ORIGINAL SLOW RELEASE WATERING BAG ON ALL CALIPER DECIDUOUS TREES SEE MANUFACTURERS DETAIL FOR SPECIFICATIONS AND DIRECTIONS.

TREE TO BEAR SAME RELATIONSHIP TO GRADE AS PREVIOUS PLANTING

MIN. 100mm DEEP SHREDDED BARK MULCH

EARTH SAUCER

1500

300

300

1000

VARIES

EXPANDABLE PROTECTIVE TREE GUARD, 200mm HIGH.

FINISHED GRADE

APPROVED NATIVE BACKFILL MATERIAL

CUT AND REMOVE TOP 1/3 OF BURLAP, WIRE, AND TWINE

UNDISTURBED SOIL

NEVER CUT A LEADER PRUNE ONLY DEAD OR DAMAGED LIMBS

2440 LONG WOOD STAKES (TYP.) ATTACH TO TREE WITH NO. 14 GALV. WIRE ENCASED WITH RUBBER GARDEN HOSE AT POINT OF CONTACT WITH TREE

NOTE: T-BAR STAKES ARE NOT TO BE DRIVEN THROUGH ROOT BALL

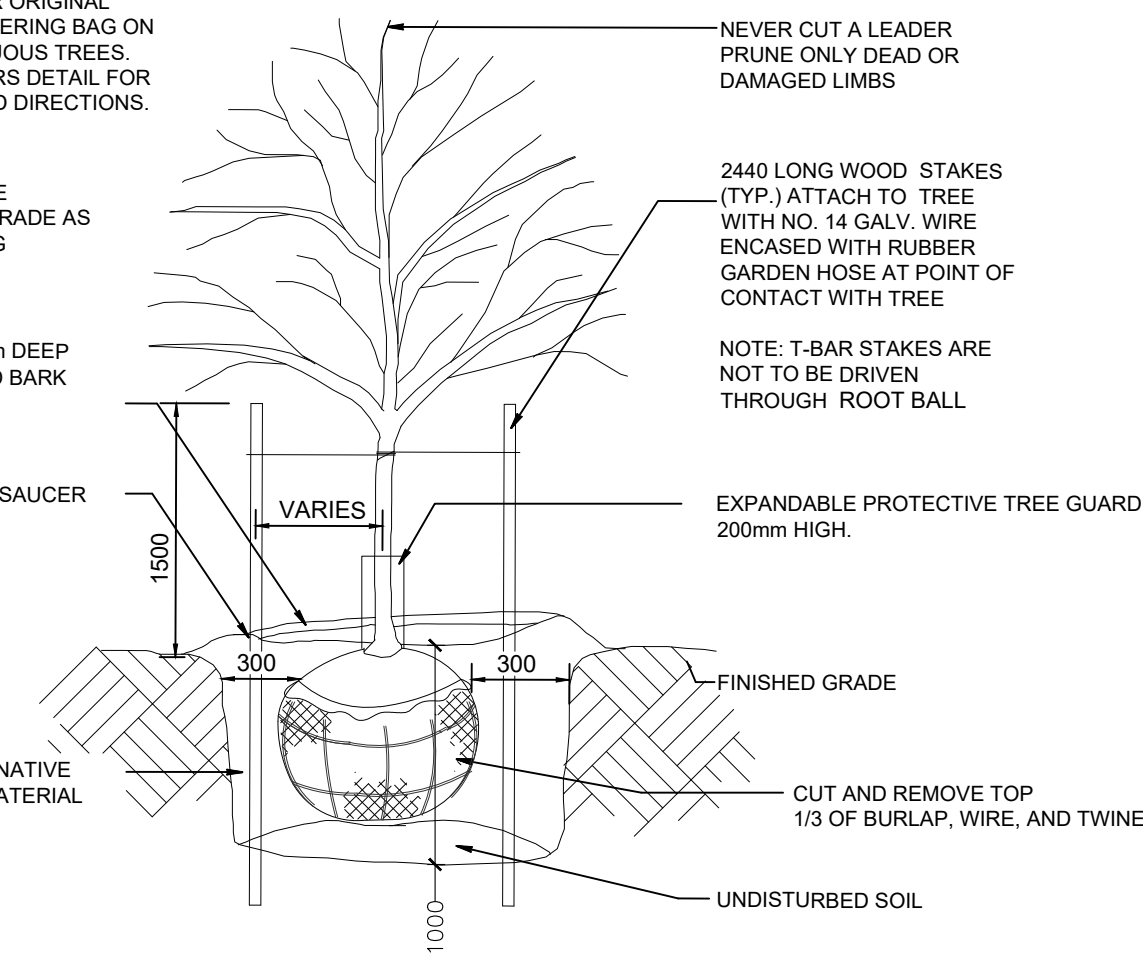

1 DECIDUOUS TREE PLANTING DETAIL  
NTS

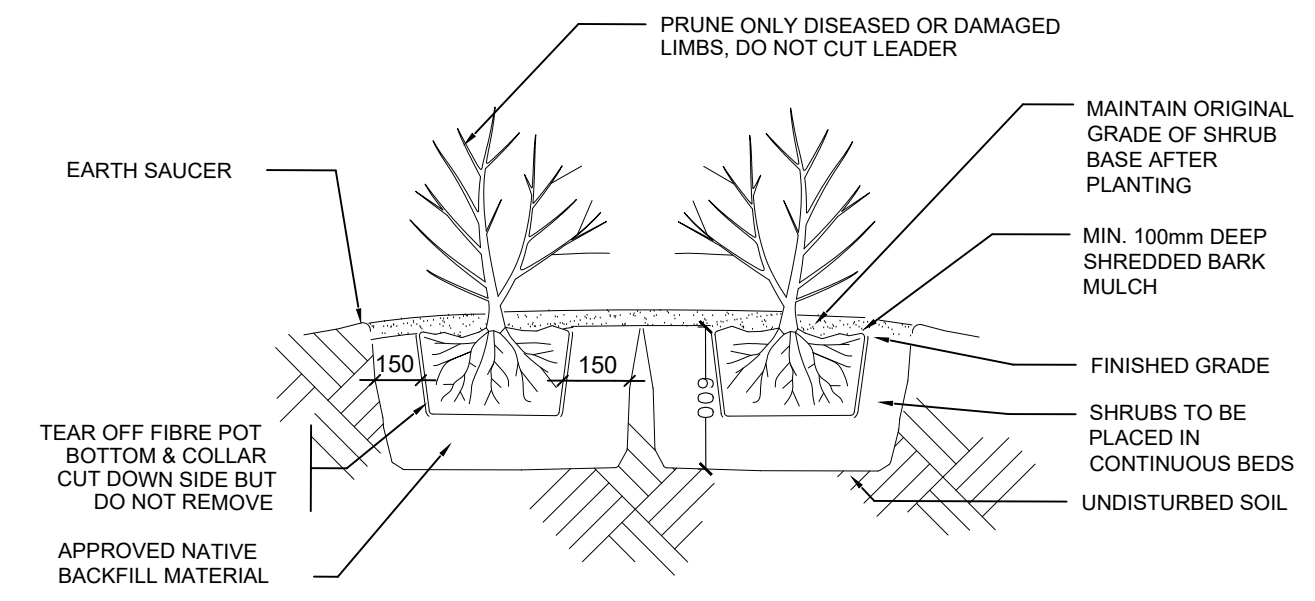

2 SHRUB PLANTING DETAIL  
NTS

PRELIMINARY  
For Discussion Purposes Only

DSH Planning Consultants Ltd.  
Mitchell Street  
Ayr, ON  
Details



PROJECT NO.: 2023-38 DRAWN BY: DPV  
SCALE: AS NOTED DESIGNED BY: DPV  
SHEET: L2 APPROVED BY: AWH  
PLOT DATE: x