



May 1, 2026

Knox United Church
92 Northumberland Street
Ayr, ON N0B 1E0

Attention: Mike Schmidt

Dear Mr. Schmidt,

**Re: Servicing Addendum
92 Northumberland Street, Ayr
Township of North Dumfries**

This letter has been prepared for the above-noted project to address the Region's comments in support of the zone change application. The Conceptual Grading Plan and Servicing Plan have been separated into two drawings as requested, and the location of the existing services has been added to the Conceptual Servicing Plan.

As stated in the Preliminary Servicing and Stormwater Management Letter prepared by Meritech Engineering dated February 27, 2025, the proposed development will generate a base domestic water demand of 0.15 L/s for the design population of 59 people at a base demand of 225 L/cap/day. The estimated firefighting flow is 195 L/s, and the maximum design velocity is 5 m/s. A 250mm diameter water service is proposed to service the proposed building.

The 6m erosion access allowance has been added to the drawings, and the proposed retaining wall has been relocated outside the erosion access allowance.

We trust the above information satisfies the Region's comments to support the zone change.

Yours very truly,

MERITECH ENGINEERING

Norm B. Litchfield, P.Eng., MBA
Director of Engineering

NBL/

Enclosures 1- Conceptual Grading Plan
2- Conceptual Servicing Plan

cc



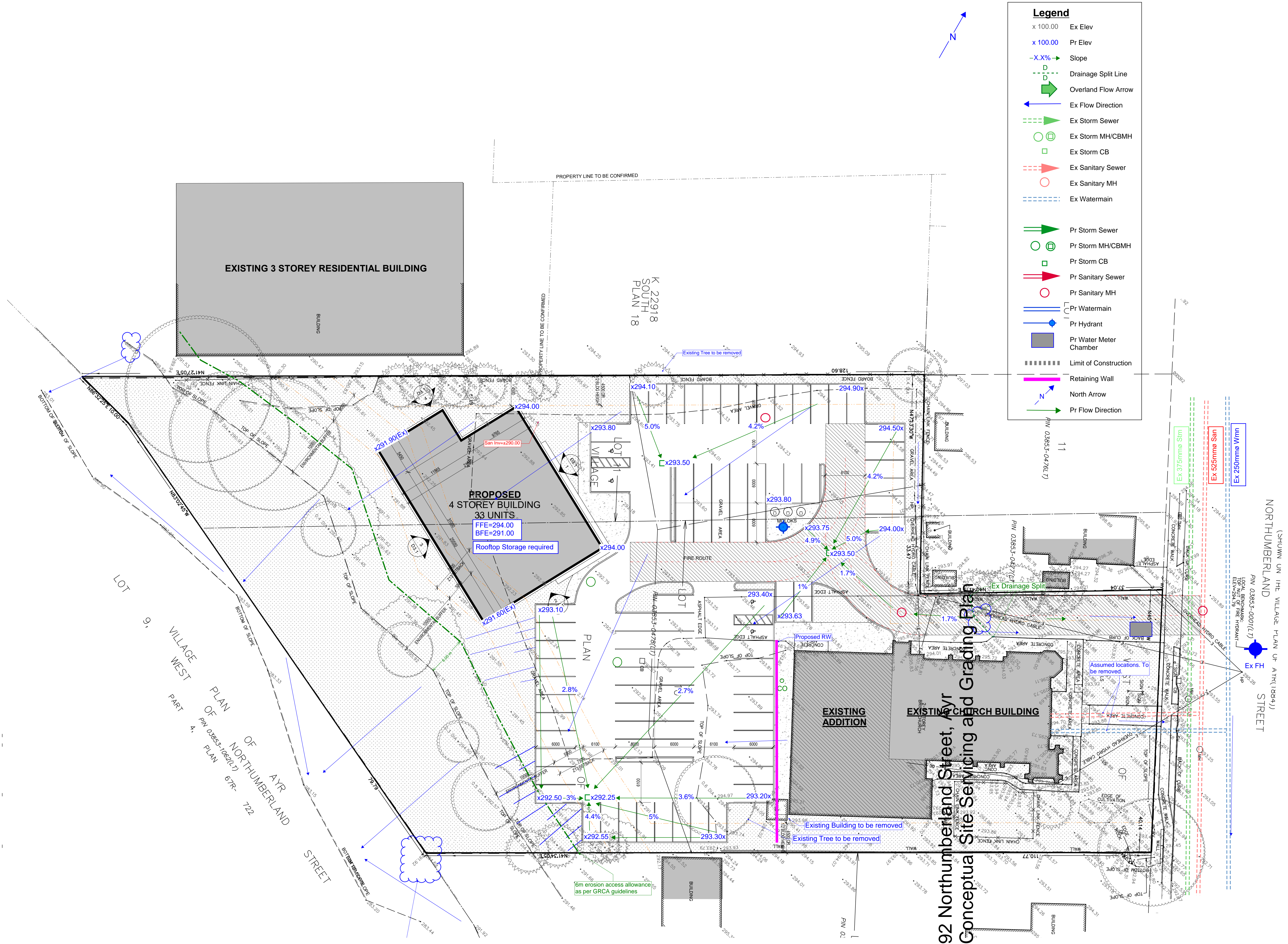

Legend	
x 100.00	Ex Elev
x 100.00	Pr Elev
-X.X%	Slope
---o---	Drainage Split Line
→	Overland Flow Arrow
←	Ex Flow Direction
→	Ex Storm Sewer
○	Ex Storm MH/CBMH
□	Ex Storm CB
→	Ex Sanitary Sewer
○	Ex Sanitary MH
---	Ex Watermain
→	Pr Storm Sewer
○	Pr Storm MH/CBMH
□	Pr Storm CB
→	Pr Sanitary Sewer
○	Pr Sanitary MH
---	Pr Watermain
◆	Pr Hydrant
■	Pr Water Meter Chamber
----	Limit of Construction
█	Retaining Wall
N	North Arrow
→	Pr Flow Direction

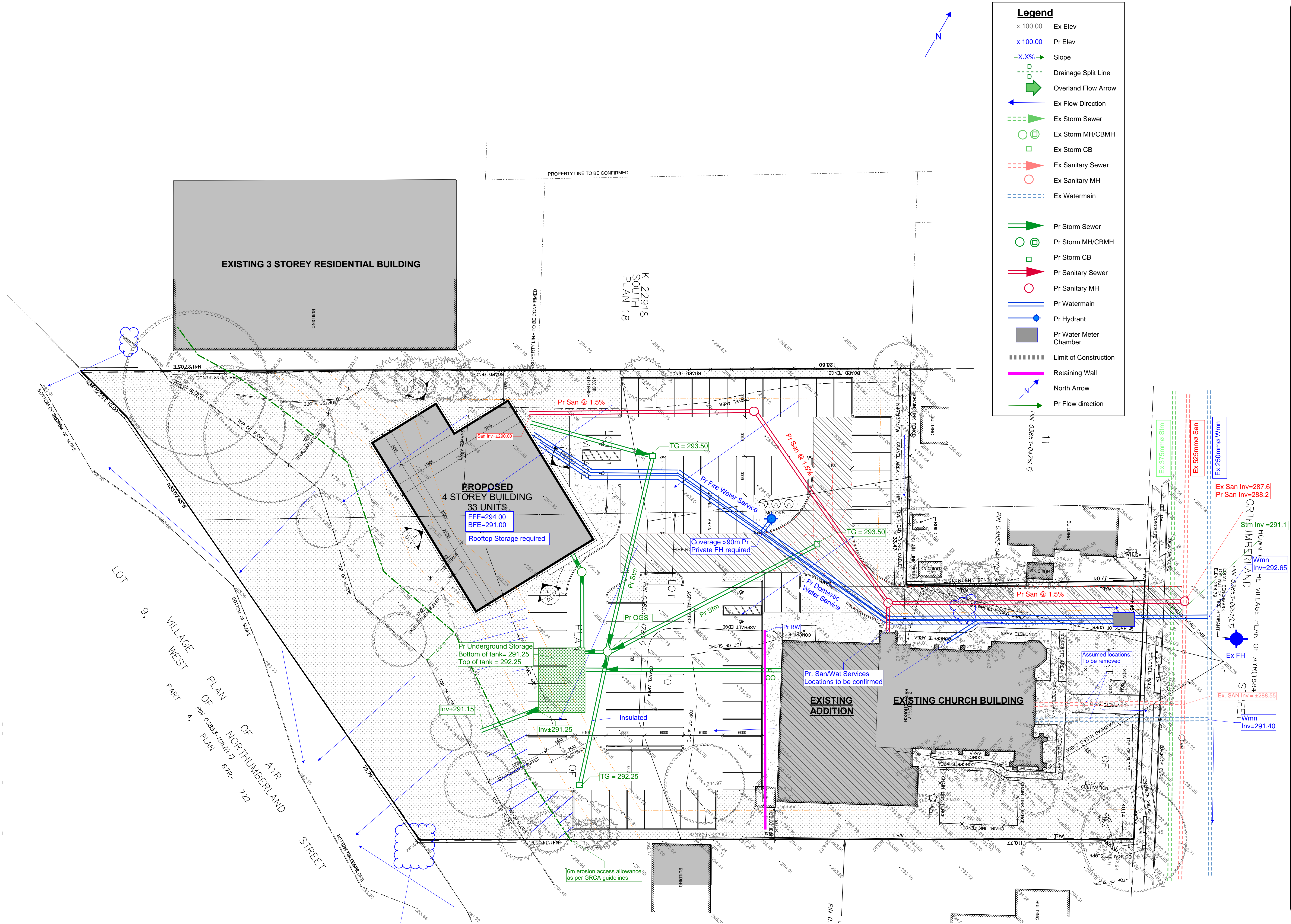

Legend	
x 100.00	Ex Elev
x 100.00	Pr Elev
-X.X%	Slope
---o---	Drainage Split Line
→	Overland Flow Arrow
←	Ex Flow Direction
---	Ex Storm Sewer
○	Ex Storm MH/CBMH
□	Ex Storm CB
---	Ex Sanitary Sewer
○	Ex Sanitary MH
---	Ex Watermain
---	Pr Storm Sewer
○	Pr Storm MH/CBMH
□	Pr Storm CB
---	Pr Sanitary Sewer
○	Pr Sanitary MH
---	Pr Watermain
◆	Pr Hydrant
■	Pr Water Meter Chamber
----	Limit of Construction
---	Retaining Wall
→	North Arrow
→	Pr Flow direction

DRAWING: 92 Northumberland Street, Ayr
 Conceptual Servicing Plan

DRAWN BY: XCC/MS
 FILE NAME: 4392.CP.pdf

CHECKED BY: CHT
 DATE: May 1, 2026

SCALE: 1:250
 Attachment 2